

Technical data sheet

Symmetrical floor support, base 400–600

Item number: 6044394



Base of the symmetrical floor support for the BKRS system, suitable for crossbeam type BSST 400/500/600. Can be used for walkable cable trays of width 400–600 mm. With threaded unions for mounting connection components, e.g. pipe clamps, as well as slots for floor mounting up to M10. Fastening material must be ordered separately.



St

Steel

FS

Strip galvanized

Master data

Item number	6044394
Type	BSSU 190 4060 FS
Description 1	Symmetrical floor support
Description 2	Lower part, up to width 600
Manufacturer	OBO
Dimension	B600mm
Colour	zinc
Material	Steel
Surface	Strip galvanized
Surface standard	DIN EN 10346
Smallest sales unit	1
Unit of quantity	Piece
Weight	118.3 kg
Weight unit	kg/100 pc.
CO2 Footprint (GWP) Cradle-to-Gate	4,8712 kg CO2e / 1 Piece

Technical data sheet

Symmetrical floor support, base 400–600

Item number: 6044394



Dimensions

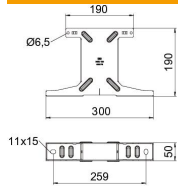

Length	50 mm
Height	190 mm
Dimension B	190 mm
Dimension L	300 mm

Technical data

Version for	Miscellaneous
Suitable for mesh cable tray	no
Suitable for cable ladder	no
Suitable for cable tray	yes
Suitable for cable support system width, max.	600 mm
Suitable for cable support system width, min.	400 mm
Tray fastening	Screw-on
Rustproof steel, pickled	no